

*Owner Manual with Parts List*

**Bolens**

15FC 02 - 15FD 02

15FC 01 - 15FD 01

**TRACTORS**

**TYPE 15FD 02  
SUPER VERSA-MATIC**

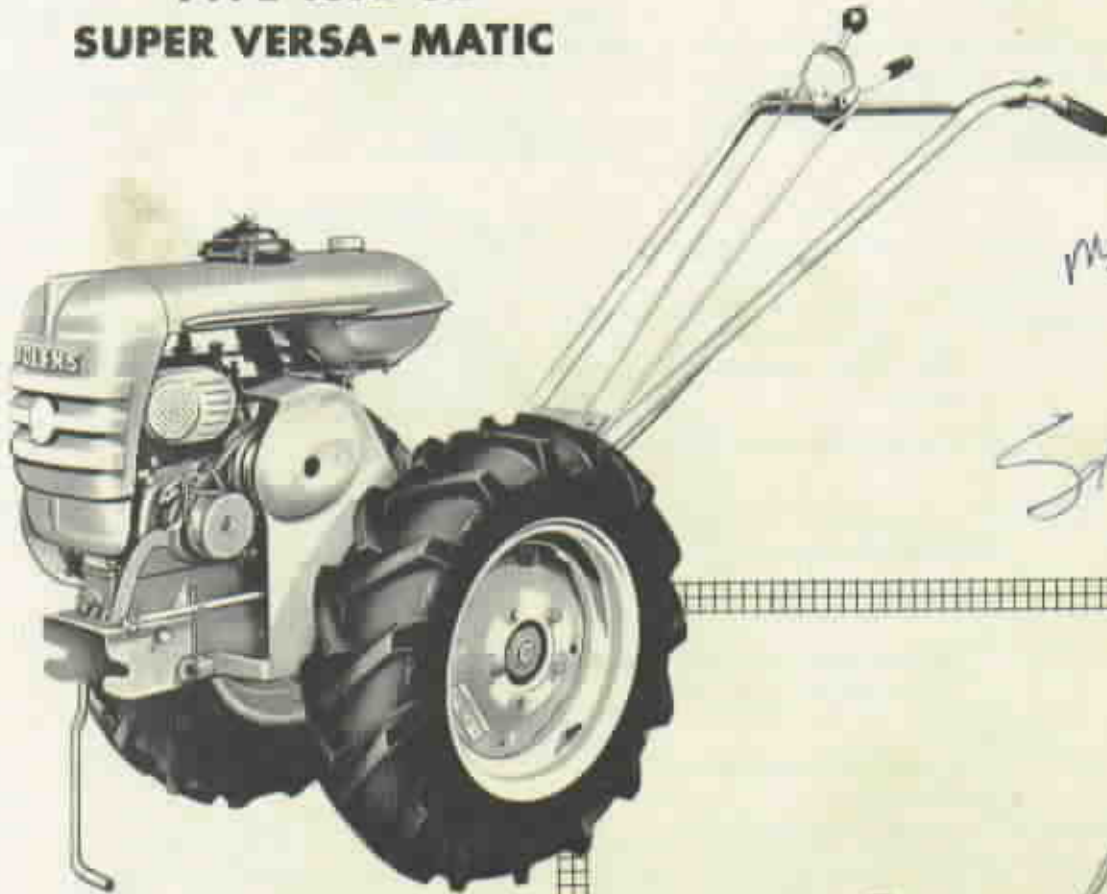

*More & More*

*Smead Bros*

**TYPE 15FC 02  
VERSA-MATIC** ▶

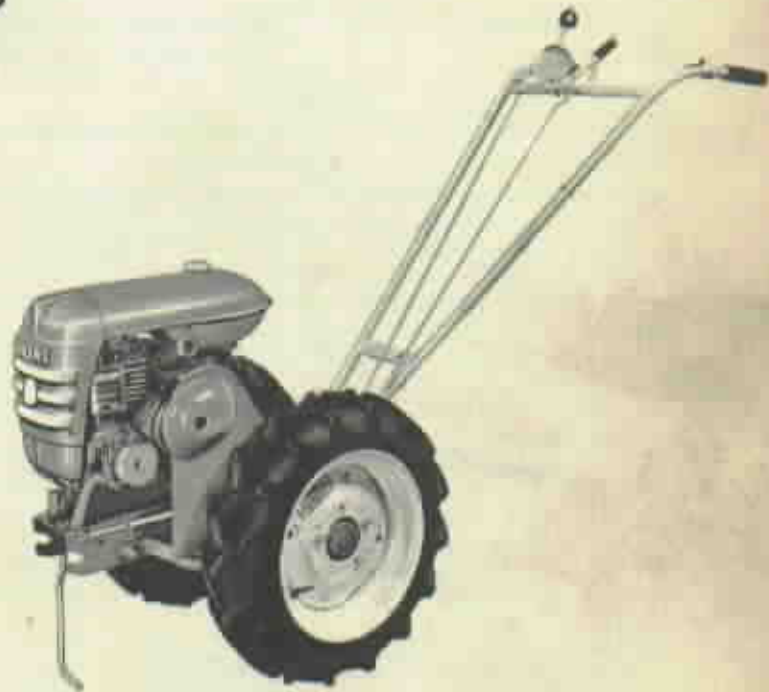

**BOLENS PRODUCTS DIVISION**

Food Machinery and Chemical Corporation

Port Washington, Wisconsin, U. S. A.

TO THE BOLENS OWNER

This Owners Manual has been especially prepared to bring to your attention all information needed to operate and maintain your tractor with maximum efficiency. Read these instructions carefully before assembling or operating the tractor. Through proper care and operation, as explained in this manual, you will obtain long, efficient service and trouble free operation from it.

Information regarding operation and maintenance of the engine is not included in this manual. A separate engine instruction manual is included with each tractor and should be consulted for all information concerning adjustments and operation.

SPECIFICATIONS

	Type 15FC01	Type 15FD01
Power	Four cycle air cooled engine with rope starter develops 2.5 H.P. at 3600 RPM -- maximum governed speed.	Four cycle air cooled engine with retracting starter develops 3.6 H.P. at 3600 RPM -- maximum governed speed.
Wheels	5-12 tires mounted on 5 inch rims	6-12 tires mounted on 5 inch rims
Primary Drive	Versa-matic drive - one control lever provides speed control from neutral to variable forward or reverse.	Versa-matic drive - one control lever provides speed control from neutral to variable forward or reverse.
Final Drive	Stamped steel gear case with machined and hardened steel gear train. Cast iron wheel hubs.	Stamped steel gear case with machined and hardened steel gear train. Cast iron wheel hubs.
Bearings	Needle type precision roller bearings.	Needle type precision roller bearings.
Speeds	Forward: Controlled variable 3:1 speed range allows any speed between 1 to 3 M.P.H. at 3600 RPM (maximum governed engine speed). Lower variable speed ranges obtained at proportionally reduced engine speeds. Reverse: 1.5 M.P.H. at 3600 RPM	Forward: Controlled variable 3.1 speed range allows any speed between 1.1 to 3.3 M.P.H. at 3600 RPM (maximum governed engine speed). Lower variable ranges obtained at proportionally reduced engine speeds. Reverse: 1.6 M.P.H. at 3600 RPM
Fuel Capacity	1 gallon	1 gallon
Tire Pressure	6 pounds	6 pounds
Crop Clearance	9-3/16 inches	10-1/16 inches
Length:		
Storage Position	29.4 inches	29.75 inches
Operating Position	66.9 inches	67.25 inches
Overall Wheel Width:		
Wheels dished inward	24.25 inches	24.25 inches
Wheels dished outward	30 inches	30 inches
Front Hitch	Patented "Snap Hitch"	Patented "Snap Hitch"

REGISTER YOUR TYPE AND SERIAL NUMBER

Register your tractor type number, serial number and engine serial and type number in the space provided below and always refer to them when writing for information or ordering parts. Complete the registration card received with the tractor and return to the factory. A nameplate showing type and serial number of the tractor is attached to the frame. The engine type and serial number is on the engine nameplate.

TRACTOR TYPE NO. \_\_\_\_\_  
 TRACTOR SERIAL NO. \_\_\_\_\_  
 ENGINE TYPE NO. \_\_\_\_\_  
 ENGINE SERIAL NO. \_\_\_\_\_

## Description

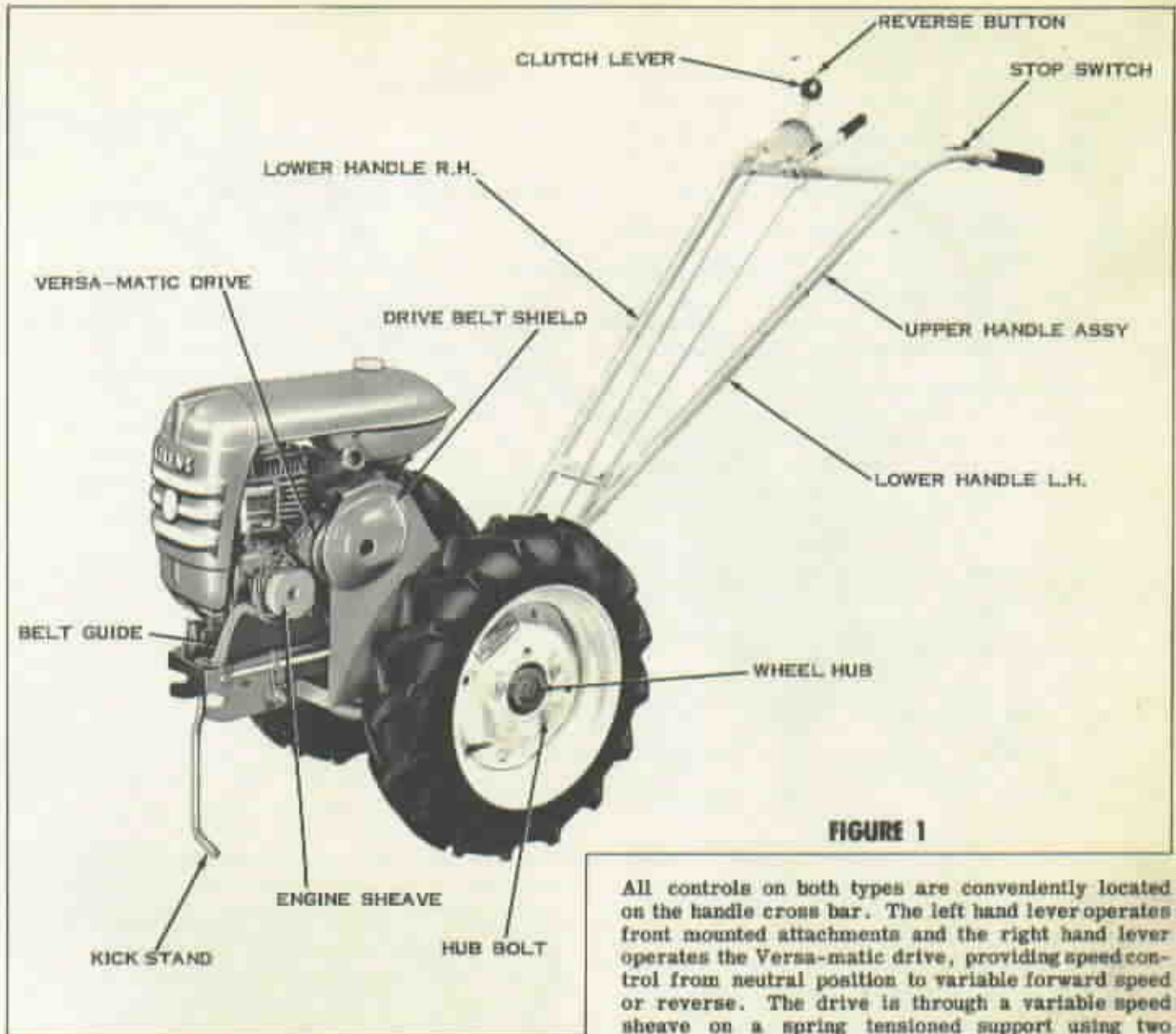

FIGURE 1

The Model 15FC Versa-matic tractor is powered by a four-cycle, air cooled engine rated at 2.5 H.P. The engine is equipped with rope starter and rotating air intake screen. 5-12 traction type tires mounted on 5 inch rims are standard equipment.

The Model 15FD Super Versa-matic tractor is powered by a four-cycle, air cooled engine, rated at 3.6 H.P., with automatic retracting starter cable and rotating air intake screen. The tractor is equipped with 6-12 traction type tires mounted on 5 inch rims.

Both tractors have as a final drive an enclosed stamped steel, grease filled gear case with machined and hardened steel gear train. Cast iron wheel hubs are driven by double acting ratchet pawls.

All controls on both types are conveniently located on the handle cross bar. The left hand lever operates front mounted attachments and the right hand lever operates the Versa-matic drive, providing speed control from neutral position to variable forward speed or reverse. The drive is through a variable speed sheave on a spring tensioned support using two special V-belts. The reverse drive is through friction discs and one V-belt.

Offset handle bars are provided for convenient and practical garden row cultivating and also close sickle bar fence operation. The handle bars are adjustable for desired height and also can be placed in vertical position for convenient storage. Retractable front kick stand and remote stop switch on handle bar are standard equipment on both types.

Front attachments are mounted on the front of the tractor frame with the Bolens patented "Snap Hitch." No tools are required for attaching the implements. The power take off for front attachments consists of a 2-1/2 inch diameter semi-deep groove sheave. The attachment idler clutch control linkage is adjustable and is a part of the tractor itself.

Rear mounted attachments are easily mounted through use of the Trigger Hitch. Again, no tools required for attaching implements, no loose parts.

## Installation

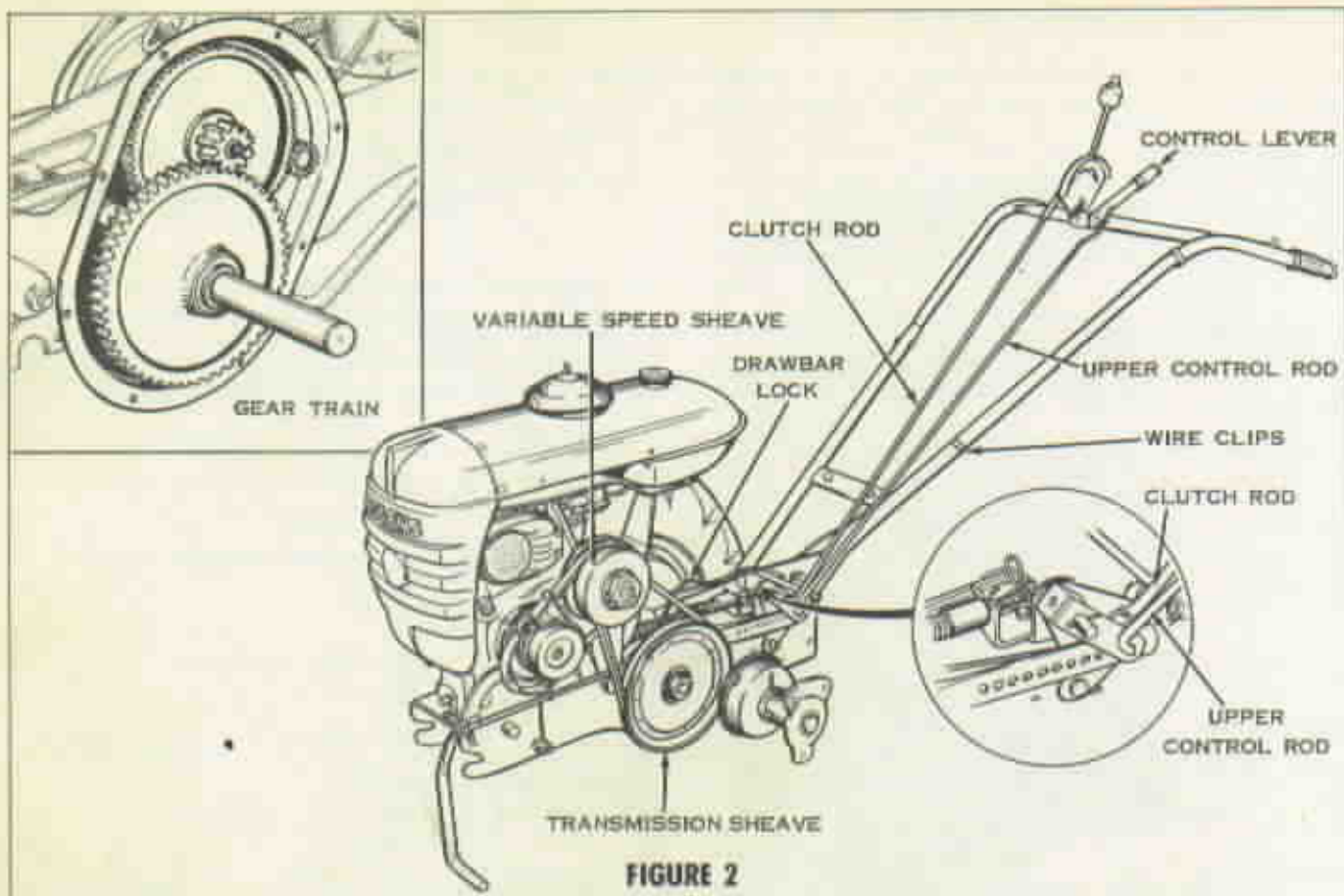

FIGURE 2

### ASSEMBLY INSTRUCTIONS

The tractor is shipped from the factory complete in one crate. The various parts in the crate consist of the tractor basic unit, wheels, upper handle, lower handle, clutch lever, attachment control rod and an accessory carton.

Join the upper and lower handle together and connect the lower handle cross braces. (Do not tighten any of the nuts until the handle is attached to the tractor). Mount complete handle assembly to the tractor fasten securely at the height desired. This setting must be completed, after wheels are installed, before installation of the clutch rod.

Mount the wheel assemblies to the tractor so they will rotate in direction indicated by arrow on tire. Hub bolts are provided in accessory carton. Attach the throttle control lever to the inside of the left handle through predrilled holes and secure with screws provided. Mount the stop switch to the top of the same tractor handle. Caution should be used in this installation so that the upper and lower insulation washers are in proper position against the handle to prevent the switch and screw from making contact with the handle which would short out the engine. Three clips are supplied in the accessory carton to hold the ground wire and throttle control cable to the tractor handle. (Refer Figure 2.)

The upper and lower attachment control rods are joined together when shipped. Remove the spring

clip and free the lower assembly. Position the lower end of the upper control rod through the left hand linkage of tractor. (Refer Figure 2.) Replace the lower control rod over the protruding rod end and secure with spring clip. Any one of the holes in the lower control rod may be used for initial installation as it will be necessary to adjust the belt tension later on when a front attachment is mounted. Place the front end of the lower rod through the guide on left front of tractor frame to hold this rod in position when front attachment is not used. Attach the free end of the upper rod through control lever on cross bar of handle and secure with cotter pin.

Install the threaded clutch rod to the clutch lever on the handle cross bar and to the right tractor linkage on the main frame. The top threaded end is to be turned into the clutch lever the necessary distance to obtain proper clutch adjustment. **NOTE: MAKE CLUTCH ROD ADJUSTMENT WHEN ENGINE IS NOT RUNNING.**

To obtain proper clutch rod adjustment test action by depressing thumb button on control lever, allowing clutch rod to move forward without pressure. Then with an additional light palm pressure on the handle ball the lever pin should go forward into the first notch of quadrant. Not Beyond! With this setting the belts will be engaged for proper tractor drive in low gear. (See Figure 3.)

## Operation

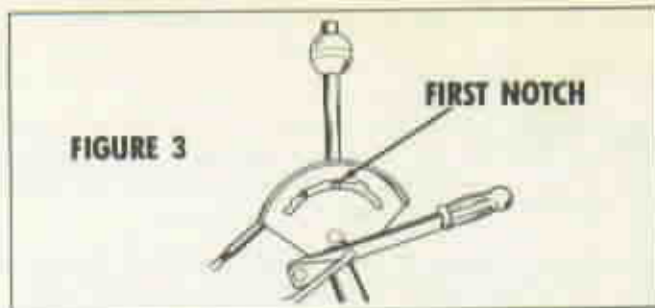

Note: Periodically check clutch rod adjustment after tractor has been in use for a period of time. Belt stretching will affect adjustment. Change in height of tractor handle will also affect control rod adjustment. Test as outlined in preceding paragraph.

### OPERATION

The 15F series tractor controls are simple and durable, designed to give long and troublefree service. It is recommended, however, that certain practical operating methods be used to assure most efficient operation. Like many other fine types of machinery, it is possible to abuse the tractor by improper handling.

**IMPORTANT:** No oil is in the crank case of engine when shipped from the factory. Before starting the engine **BE SURE TO FILL THE CRANK CASE AND AIR CLEANER TO THE LEVEL INDICATED WITH THE RECOMMENDED LUBRICANT SPECIFIED IN THE ENGINE MANUAL.** Further instructions pertaining to the engine, its care and lubrication are contained in the engine manual; read these instructions carefully.

### LUBRICATION

Proper lubrication is a very important factor for long life and satisfactory performance of your tractor. There are eight high pressure grease fittings on the tractor. (Refer to Figures 7, 8, and 9 for locations.) Lubricate each grease fitting approximately every 8 to 10 hours of operation. Clean all fittings carefully before applying regular pressure gun lubricant. Periodically lubricate working parts of tractor with light oil for smooth operation.

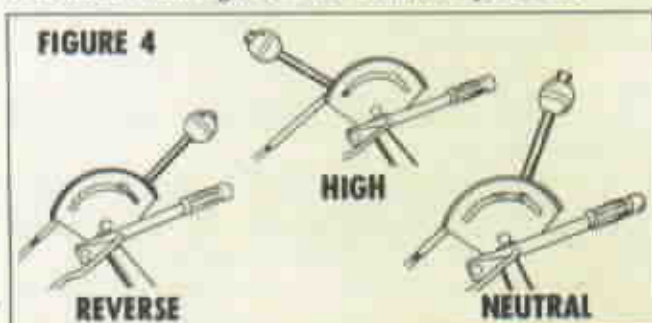

### OPERATION

Before starting engine be sure right hand clutch lever is in the neutral position and the left control lever in the forward position when front attachment is mounted. If no front attachment is mounted the control

lever should be to the rear in the engaged position. (Refer to Figure 4 for speed controls of clutch lever.) After the engine is running, to start tractor, press center clutch button down and move lever forward to desired forward speed. When going from forward to neutral the control button should not be depressed. Come to neutral slowly (2 seconds), allow the tractor to stop. Then depress button and pull the control handle back into reverse. **DO NOT** jerk the control handle from full load forward to immediate reverse without stopping. This action brings the Versa-matic drive unit forward and in direct contact with the engine sheave. It is necessary to hold the clutch lever in this position when reversing the tractor. Do not use the reverse for a brake (F783 Brake Kit is available for use in terrain where frequent braking is necessary). Use the same care in regard to your tractor that you would with an automobile. To stop the engine, hold down stop switch on left tractor handle until engine stops.

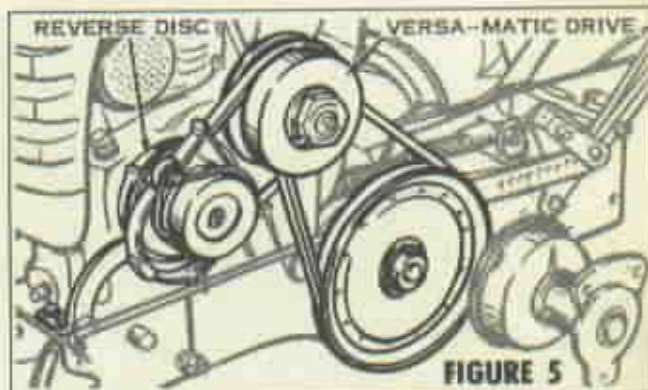

### VERSA-MATIC DRIVE

The Versa-matic drive instantly varies the forward ground speed of the tractor (1 to 3 M.P.H.) and provides a safety type reverse. Moving the clutch lever forward from neutral moves the Versa-matic drive sheave backward, thus tightening the belt from the engine drive sheave. The further the clutch lever is moved forward the tractor forward speed increases. This variation of speed is controlled by the construction of the Versa-matic drive which consists of a double sheave with a floating center section. As the clutch lever is moved forward the Versa-matic drive is moved backward allowing the belt to run lower in the sheave. This decreases the diameter of the section driven by the belt from the engine, forces the center floating section over and increases the diameter of the section driving the countershaft sheave. These simultaneous changes in diameters increase the tractor speed. **DO NOT** force the Versa-matic control lever forward unless the engine is running.

### TRACTOR DRIVE

The tractor is driven by a belt from the engine to the Versa-matic drive sheave and a second belt running from the Versa-matic drive sheave to the countershaft sheave. The opposite end of the countershaft is connected to the gear reduction unit which drives directly on the tractor axle.

## Operation

### DRIVE BELT REPLACEMENT

On 15FC - Using pliers or steel hook, grasp front spring hook (item 47, Figure 9), pull forward to release hook from frame and allow spring to compress.

On 15FD - Remove cotter pin or spring cotter, located immediately in front of nut, from link rod (item 103, Figure 9). Place Versa-matic control in neutral. Turn up nut on rod threads until able to lift rod from anchor clip, relieving spring tension.

Refer to the sketch (Figure 6) for proper alignment of the belt guide assembly. This alignment must be carefully made with the belts engaged. Set control lever in first notch of quadrant.

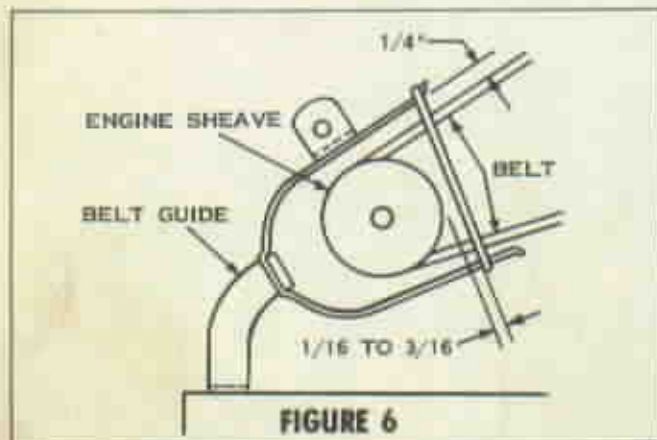

### WHEEL HUBS

The hubs are designed so they are free wheeling in either forward or reverse, allowing the outside wheel to run faster when turning the tractor. The wheel hub ratchets which allow this differential action are double operating ratchet pawls which will operate either in a forward or reverse direction.

### TIRE PRESSURE

Keep tires inflated to 5 pounds pressure at all times. Liquid filled tires should always be checked for pressure with the valve at top position.

### KICK STAND

The front kick stand is easily operated by pulling sideward and then downward. It automatically latches to main frame when swinging backward. The stand does not need to be removed when attaching front mounted units.

### WHEEL SETTINGS

Two wheel settings are available on 15FC02 and 15FDC2. With the wheels dished inward the setting is 24.25 inches, over all. By dishing wheels out-

ward the width can be increased to 30 inches.

### DRIVE HUB PAWLS

Both wheels on the 15F series tractors are equipped with double acting pawl assemblies. These pawls are keyed to the main drive shaft and are actuated by movement of this shaft.

When the tractor is moving forward and stopped, the pawls will still be engaged in a forward operating position, therefore, the tractor cannot be manually pulled backward without turning the entire gear case mechanism. However, a slight forward manual movement of the tractor will allow the pawls to override the cogs in the wheel hub, placing the pawls in a neutral position, and allow free-wheeling of the tractor. The same applies when reversing, making it necessary to manually pull the tractor backward for release of the pawls. Of course, placing the tractor under power, opposite of the last direction of travel, will immediately properly actuate the pawls.

### GEAR TRAIN

The gear train is originally lubricated at the factory with 1/2 lb. of "all purpose" oil being provided in it. This amount of lubricant should last for a considerable length of time unless for some reason the oil leaks from it. If any leakage is noted the gasket and cover should be checked for tightness. An occasional lubrication of grease thru the top grease fitting is recommended but care should be taken not to over lubricate the gear train. The plug on side of cover is not an oil level plug. This is provided for removal of the gear train shaft.

### TRACTOR CARE

Keep the tractor sheltered from the weather when not in use. At the end of each season it is advisable to have your Bolens dealer give your tractor a thorough check-up for longer tractor life and better performance.

### ORDERING PARTS INSTRUCTIONS

In appointing Bolens agencies consideration has been given to their ability to provide prompt and efficient service. We recommend that your local dealer be contacted for your service requirements. He will furnish correct parts from his stock or order them for you if necessary.

To insure getting correct materials without delay please supply the following information. Please print to avoid errors.

1. The type number of the tractor and serial number stamped on the nameplate.
2. When ordering engine parts give engine serial and type number as stamped on engine plate.
3. Quantity, part number, and description of each part wanted.
4. Advise as to whether parts should be shipped by mail, express or freight. (All repair orders are shipped F.O.B. factory.)
5. Name, shipping address and mail address.

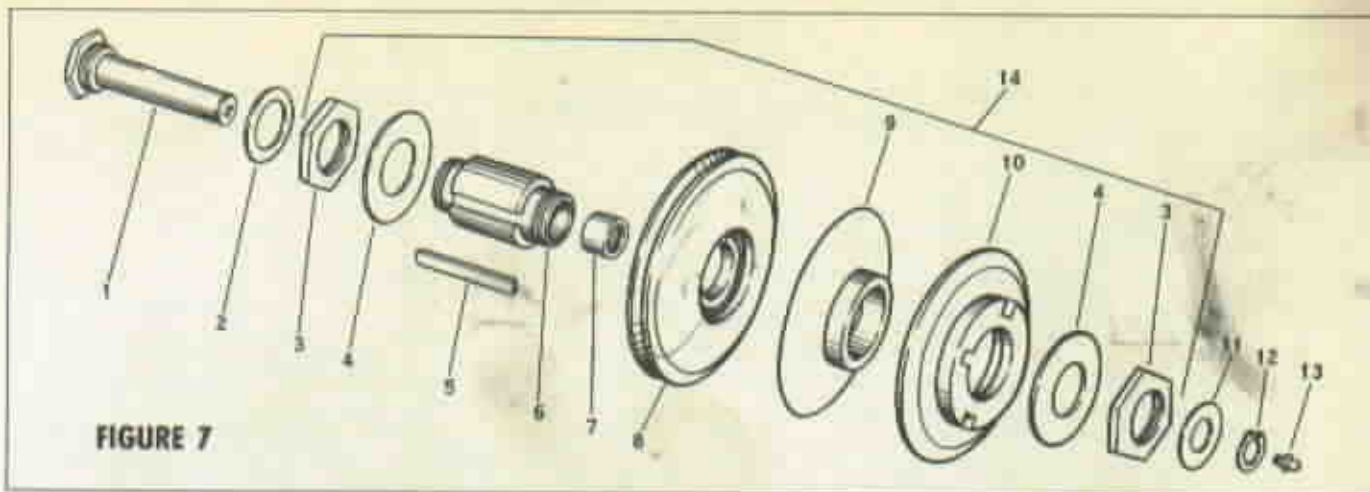

FIGURE 7

VARIABLE SHEAVE ASSEMBLY

Ref. No.	Part No.	Description	No. Req'd.
1	1705012	Variable Speed Sheave Shaft	1
2	1703073	Thrust Washer	1
3	1705011	Nut	2
4	1705032	Washer	2
5	1704979	Key	1
6	1704980	Sleeve	1
7	1185074	Needle Bearing	2

Ref. No.	Part No.	Description	No. Req'd.
8	1704951	Inner Flange	1
9	1704976	Center Flange	1
10	1704978	Outer Flange	1
11	1705093	Washer Spacer	As Req'd.
12	1118808	Retaining Ring	1
13	1104954	Grease Fitting	1
14	1705180	Sheave Assy (Items 3 thru 10)	1

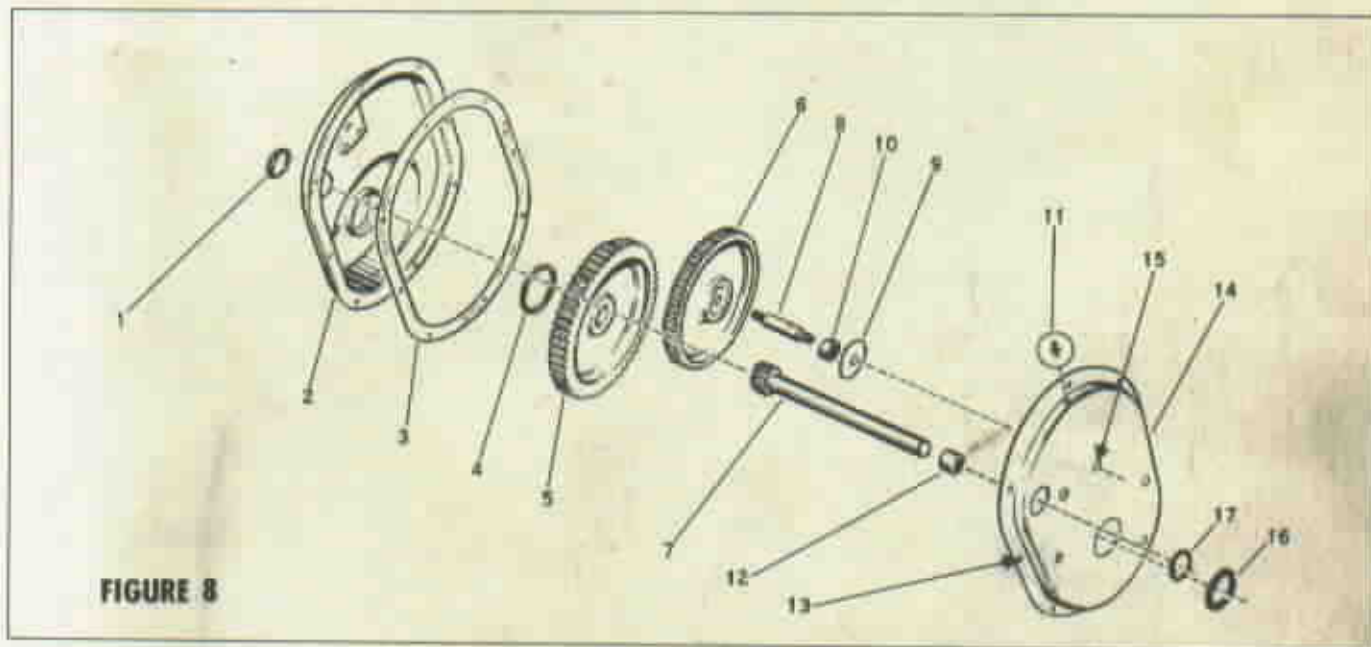

FIGURE 8

TRANSMISSION ASSEMBLY

Ref. No.	Part No.	Description	No. Req'd.
1	1703056	Plug	1
2	1702909	Gear Cover	1
3	1703055	Gasket	1
4	1703054	Seal	1
5	1702917	Gear - 53T	1
6	1703942	Cluster Gear (w/Bearing)	1
7	1702953	Shaft	1
8	1702951	Stud Bolt	1
9	1703052	Washer	1

Ref. No.	Part No.	Description	No. Req'd.
10	1185165	Needle Bearing	2
11	1104954	Grease Fitting	1
12	1185074	Needle Bearing	2
13	1185251	Pan Hd. Screw	8
14	1702907	Gear Case	1
15	1703051	Bolt	2
16	1705118	Seal	1
17	1705117	Seal	1

TYPES 15FC02-15FD02

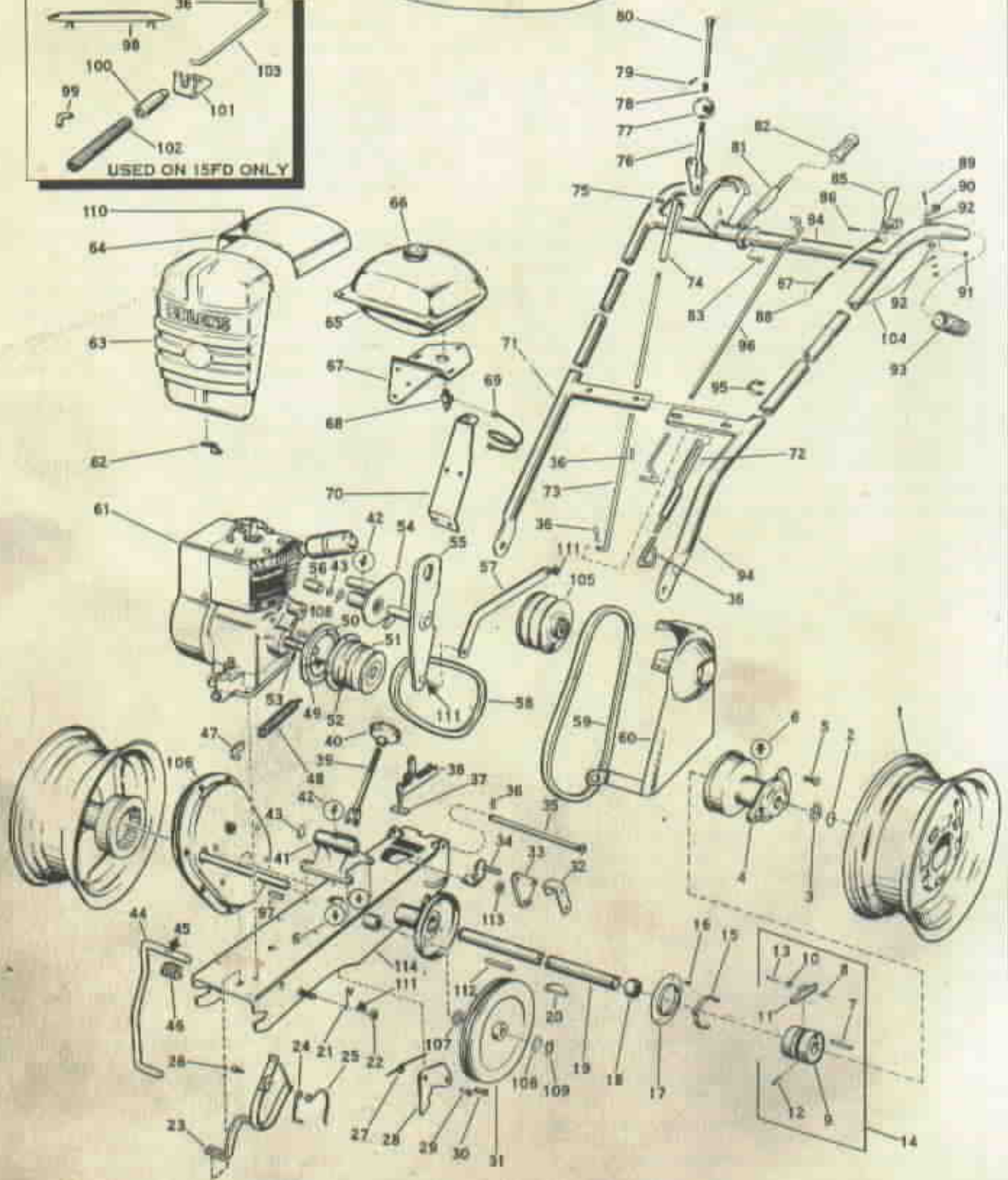
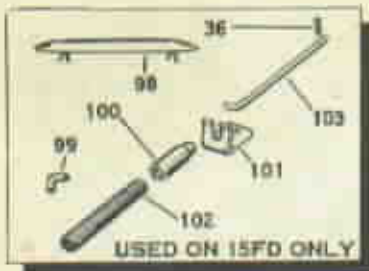

FIGURE 9



PARTS LIST

This parts list covers models 15FC02 and 15FD02. Where differences between models occur the model of the tractor on which the part is used follows name of part in parentheses.

Ref. No.	Part No.	Description	No. Req'd.	Ref. No.	Part No.	Description	No. Req'd.
1	1700953	Wheel	2	62	1703673	Grille Support (15FC)	1
2	1118554	Retaining Ring	2	63	1703621	Grille	1
3	1703073	Thrust Washer	5	64	1703572	Hood (15FD)	1
4	1706012	Hub	2		1703625	Hood (15FC)	1
5	101085	Hub Bolt	5	65	1701520	Gas Tank (Inc. Cap)	1
6	1104954	Grease Fitting	4	66	1703130	Cap	1
7	1703072	Pin	2	67	1703623	Tank Support (15FD)	1
8	1705119	Bowed Washer	2		1703082	Tank Support (15FC)	1
9	1702857	Drive Hub	2	68	1702550	Outlet	1
10	1705108	Washer	2	69	1703701	Fuel Line (15FD)	1
11	1702961	Hub Pawl	2		1703472	Fuel Line (15FC)	1
12	1703066	Roll Pin	4	70	1703622	Brace (15FD)	1
13	1705106	Drive Pin	2		1702933	Brace (15FC)	1
14	1705281	Pawl & Hub Assy (7 thru 13)		71	1702888	Lower Handle, RH	1
15	1703071	Spring	2	72	1703550	Control Rod	1
16	1185164	Thd. Cutting Screw	6	73	1702026	Lower Rod	1
17	1703070	Spring Flange	2	74	1703064	Control Rod Bracket	1
18	1187181	Needle Bearing	2	75	1703090	Pin	1
19	1702867	Axle	1	76	1704996	Control Lever	1
20		Woodruff Key, 1/4 x 1-1/8	1	77	1703067	Knob	1
21	1704391	Latch	1	78	1703065	Spring	1
22	1100194	Nut	1	79	1185256	Drive Pin	1
23	1705014	Belt Guide	1	80	1704994	Lever Plunger	1
24	1703540	Belt Stop	1	81	306878	Lever	1
25	1704260	Belt Stop	1	82	180886	Handle Grip	1
26		Hex. Cap Screw, 1/4-20 x 3/4	1	83	130147	Pin	1
	1110106	Nut	1	84	1705013	Upper Handle	1
27	1703058	Spring	1	85	182694	Throttle Lever	1
28	1703057	Latch	2	86		Rd. Hd. Screw, 10-24 x 1-1/4	2
29	1703060	Pin	1	87	1701080	Throttle Housing	1
30	1703061	Pin	1	88	1703626	Throttle Wire (15FD)	1
31	1703063	Sheave	1		1701079	Throttle Wire (15FC)	1
32	1704973	Control Link	1	89		Rd. Hd. Screw, 8-32 x 1-1/2	1
33	1704972	Pivot Arm	1	90	1700213	Switch	1
34	1704970	Control Bracket	1	91	1703554	Acorn Nut	2
35	1703095	Mach. Bolt, 3/8-16 x 7-1/2	1	92	1701051	Shoulder Bushing	2
36	1703011	Clip	4	93	1703539	Handle Grip	2
37	1703063	Pivot Hinge	1	94	1702889	Lower Handle, LH	1
38	1703870	Draw Bar	1	95	149925	Cable Clip	3
39	1703059	Latch Rod	1	96	1703097	Control Rod	1
40	229358	Hand Wheel	1	97	1185001	Key	1
41	1704890	Pivot Support	1	98	1703829	Hood Moulding (15FD)	1
42	1110086	Grease Fitting	2	99	1106525	Elbow (15FD)	1
43	1705092	Special Washer	As Req'd.	100	1703576	Spacer (15FD)	1
44	1704690	Kick Stand	1	101	1703577	Anchor (15FD)	1
45	1704692	Drive Pin	1	102	1703575	Spring (15FD)	1
46	1704691	Spring	1	103	1703618	Link (15FD)	1
47	1702943	Spring Hook (15FC)	1	104	1701288	Ground Wire	1
48	1703092	Spring (15FC)	1	105		Variable Sheave (See Fig. 7)	
49		Rd. Hd. Screw, 10-32 x 3/4	4	106		Transmission (See Fig. 8)	
50	1704965	Reverse Disc	1	107		Flat Washer, 5/8	1
51	1704952	Engine Sheave (15FC)	1	108	1705093	Spacer	As Req'd.
	1704953	Engine Sheave (15FD)	1	109	1118808	Retaining Ring	1
52		Set Screw, 5/16-18 x 3/8	2	110	1185109	Thd. Cutting Screw	5
53		Sq. Key, 3/16 x 1	1	111	1703616	Bowed Washer	3
54	1705102	Spring Link (Inc. Bearings)	1	112	1703053	Key	1
55	1704988	Pulley Link	1	113	1700065	Bowed Washer	1
56	1185166	Bearing	2	114	1704699	Frame	1
57	1705016	Control Link	1			ACCESSORIES (NOT ILLUSTRATED)	
58	1705033	Belt, 22 in.	1		1703019	Wrench	1
59	1705034	Belt, 35 in.	1		180301	Grease Gun	1
60	1703555	Belt Shield	1		350002	Hex. Key, 3/8	1
61		Engine K-90 (15FD)	1		350004	Hex. Key, 5/16	1
61		Engine B&S Model "B" (15FC)	1		1701422	Oil Filler	1
62	1702578	Grille Support (15FD)	1				

TYPES 15FC01-15FD01

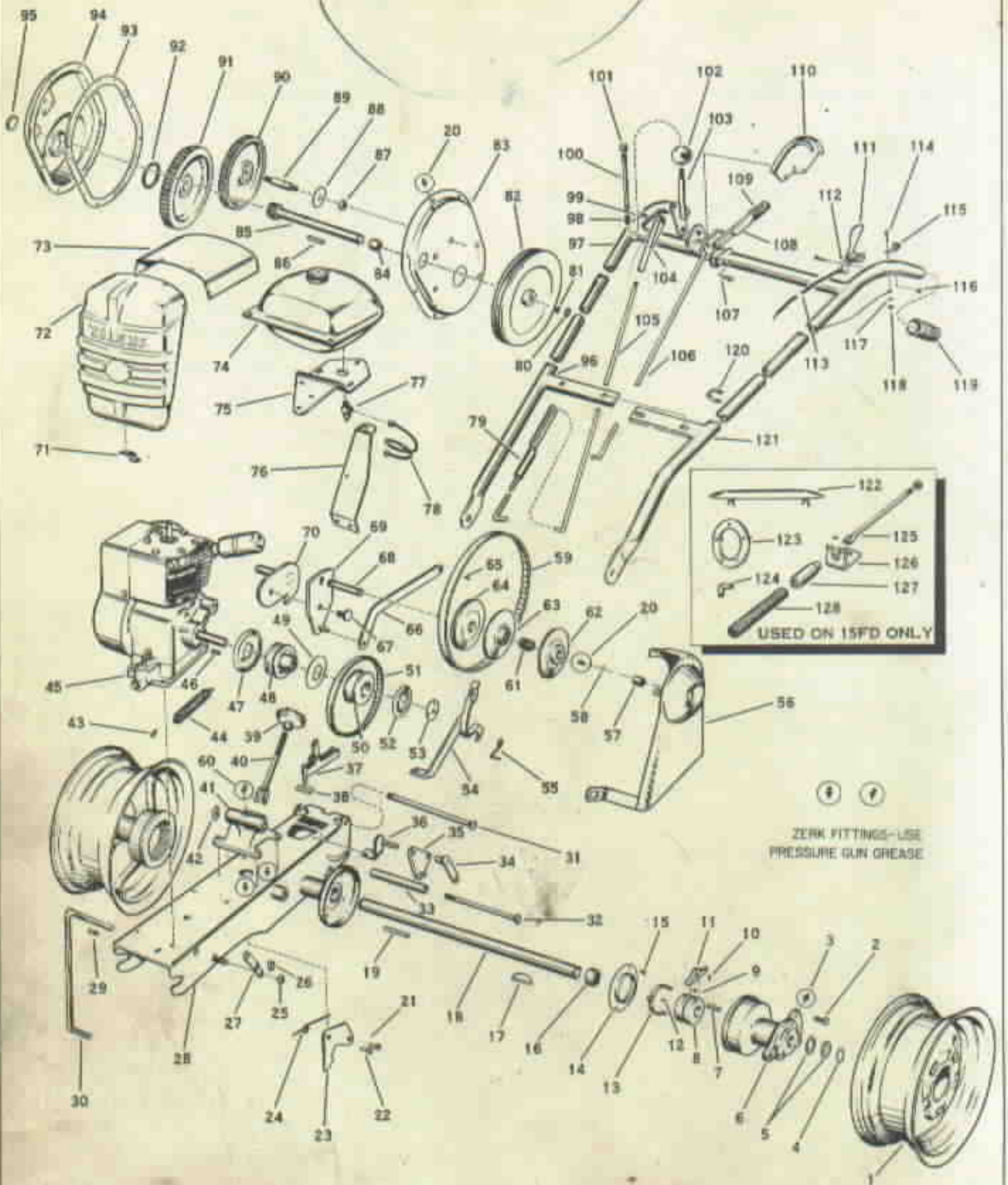
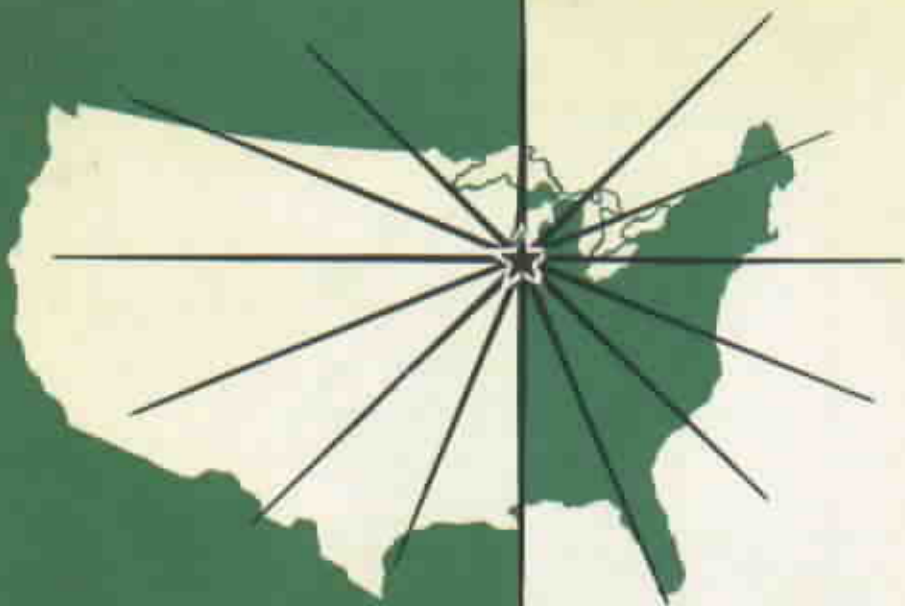

FIGURE 11

## PARTS LIST

This parts list covers models 15FC01 and 15FD01. Where differences between models occur the model of the tractor on which the part is used follows name of part in parenthesis.

Ref. No.	Part No.	Description	No. Req'd.	Ref. No.	Part No.	Description	No. Req'd.
1	1700853	Wheel, 5 in.	2	68	1702954	Shaft	1
2	101085	Hub Bolt (15FC)	6	69	1702937	Pulley Link Assy	1
	1703460	Hub Bolt (15FD)	6	70	1702939	Spring Link	1
3	1104954	Grease Fitting (15FC)	2	71	1703673	Grille Support (15FC)	1
	1100758	Grease Fitting (15FD)	2		1703578	Grille Support (15FD)	1
4	1118354	Retaining Ring	2	72	1703621	Grille	1
5	1703073	Thrust Washer	2	73	1703625	Hood (15FC)	1
6	1702886	Wheel Hub	2		1703572	Hood (15FD)	1
7	1703072	Drive Pin	2	74	1701520	Gasoline Tank	1
8	1702857	Drive Hub	2	75	1703082	Tank Support (15FC)	1
9	1703618	Washer	2		1703623	Tank Support (15FD)	1
10	1703914	Grommet	2	76	1702933	Tank Brace (15FC)	1
11	1702961	Drive Hub Pawl	2		1703622	Tank Brace (15FD)	1
12	1703066	Pin	2	77	1702550	Tank Outlet	1
13	1703071	Friction Spring	2	78	1703472	Fuel Line (15FC)	1
14	1703070	Friction Spring Flange	2		1703701	Fuel Line (15FD)	1
15	1185164	Screw Thd. Cutting No. 8-32 x 3/8	6	79	1703550	Control Rod	1
16	1187181	Needle Bearing	2	80	1118808	Retainer Ring	1
17	1181093	Woodruff Key, 1/4 x 1-1/2	1	81	1701074	Washer	1
18	1702867	Axle	1	82	1703083	Sheave	1
19	1703053	Sq. Key, 1/4 in.	1	83	1702907	Gear Case	1
20	1104954	Grease Fitting	4	84	1185074	Needle Bearing	2
21	1703061	Pin - Rod End	1	85	1702953	Shaft Assy	1
22	1703060	Pin	1	86	1185001	Sq. Key, 1/8 x 1	1
23	1703057	Latch Strap Hitch	2	87	1185165	Needle Bearing	2
24	1703058	Spring	1	88	1703052	Washer	2
25	1103905	Stop Nut	1	89	1702951	Stud Bolt	1
26	1703619	Clip	1	90	1703542	Cluster Gear (With Bearings)	1
27	1704391	Control Rod Latch	1	91	1702917	Gear - 53T	1
28	1702860	Frame	1	92	1703054	Seal	1
29	1702931	Spring	1	93	1703055	Gasket	1
30	1702946	Kick Stand	1	94	1702900	Gear Cover	1
31	1703095	Bolt - Hex Hd. Mach, 3/8-16 x 7-1/2	1	95	1703056	Plug Button (With Rubber Gasket)	1
32	1703096	Bolt - Hex Hd. Mach, 3/8-16 x 6	1	96	1702888	Handle Lower R. H.	1
33	1702945	Spacer	1	97	1702887	Handle Upper	1
34	1702927	Idler Control Link	1	98	1703065	Latch Spring	1
35	1702894	Pivot Arm	1	99	1703090	Pin	1
36	1702819	Control Link Bracket	1	100	1702940	Plunger	1
37	1702870	Draw Bar	1	101	1702934	Button	1
38	1703063	Lower Pivot Hinge	1	102	1703067	Knob	1
39	229358	Hand Wheel	1	103	1702966	Lever	1
40	1703059	Latch Rod	1	104	1703064	Control Rod Bracket	1
41	1702980	Pivot Support	1	105	1702926	Lower Control Rod	1
42	1701074	Spacer Washer	As Req'd.	106	1703097	Upper Control Rod	1
43	1702943	Spring Hook (15FC)	1	107	130147	Pin	1
44	1703092	Belt Spring (15FC)	1	108	308878	Idler Throwout Lever	1
45		Engine - Model 8, B and S (15FC)	1	109	180886	Grip	1
		Engine - Model K90 (15FD)	1	110	1702962	Speed Control Sector	1
46	1104238	Sq. Key, 3/16 x 1	1	111	182694	Throttle Unit	1
47	1703532	Reverse Disc	1	112	1701079	Control Wire (15FC)	1
48	1703533	Engine Sheave (15FC)	1		1703626	Control Wire (15FD)	1
	1703546	Engine Sheave (15FD)	1	113	1701080	Control Wire Housing	1
49	1703534	Friction Washer	1	114	1118117	Screw, Rd. Hd. Mach. No. 8-32CP	1
50	1703535	P. T. O. Sheave	1	115	1700213	Grounding Switch	1
51	1705001	Engine Belt 20"	1	116	1185098	Lock Washer No. 88AE Med.	1
52	1703536	Belleville Spring	1	117	1187293	Flat Washer No. 88AE Std.	1
53	1703537	Collar	1	118	1701051	Bushing	2
54	1705014	Belt Guide	1	119	1702530	Flex Grip	2
55	1702940	Belt Stop	2	120	140025	Cable Clip	3
56	1703555	Belt Shield	1	121	1702989	Handle Lower L. H.	1
57	1185074	Needle Bearing	2	122	1703829	Hood Moulding (15FD)	2
58	1118808	Retaining Ring	1	123	1703029	Wheel Spacer (15FD)	2
59	1705034	Transmission Belt 35"	1	124	1106525	Elbow (15FD)	1
60	1110086	Grease Fitting	1	125	1703618	Link Assy (15FD)	1
61	1702957	Sleeve	1	126	1703577	Anchor (15FD)	1
62	1702956	Outer Sheave Flange	1	127	1703576	Spacer (15FD)	1
63	1702963	Control Sheave Flange	1	128	1703575	Belt Spring (15FD)	1
64	1702978	Inner Sheave Flange	1	ACCESSORIES (NOT ILLUSTRATED)			
65	1700111	Drive Stud	3	350002	Set Screw Key for 3/8	1	
66	1702935	Control Link	1	350004	Set Screw Key for 5/16	1	
67	1702924	Joint Bolt	1	180301	Grease Gun	1	
				1703018	Wrench	1	
				1701422	Oil Filler	1	



**NATION WIDE  
SERVICE . . . .  
GENUINE  
FACTORY  
REPAIR PARTS**

The Bolens Products Division of Food Machinery and Chemical Corporation has established a nation wide reputation for quality products. This reputation, gained through advanced engineering and efficient manufacturing methods is important to remember when buying replacement parts.

Genuine Bolens parts assure the continued high performance originally built into your equipment. Bolens dealers are appointed on their ability to provide prompt efficient service, and are backed by the Bolens service organization. When replacing parts consult your nearest Bolens dealer for **GENUINE BOLENS SERVICE PARTS**.

When buying new equipment, remember the protective service offered through the Bolens dealer in your community.

**PIONEER MANUFACTURERS  
OF GARDEN TRACTORS  
AND EQUIPMENT**



***Bolens Products Division***

**FOOD MACHINERY AND CHEMICAL CORPORATION  
PORT WASHINGTON, WISCONSIN**